

house.

PARTNERSHIP

Moving estate agency on



h.

GILTAR

19 Woodlands Park
Spinney Hill
Addlestone KT15 1AG

Positioned in a pretty cul-de-sac, an opportunity to improve and extend this well-planned bungalow

- Porch and entrance hall
- Sitting / dining room
- Kitchen
- 2 bedrooms
- Bathroom
- Attached single garage
- Gardens
- Driveway parking
- Cul-de-sac
- EPC: E



h.



h.



properties perfectly presented



h.

Approximate Gross Internal Area = 74.6 sq m / 803 sq ft
Garage = 12.5 sq m / 134 sq ft
Total = 87.1 sq m / 937 sq ft

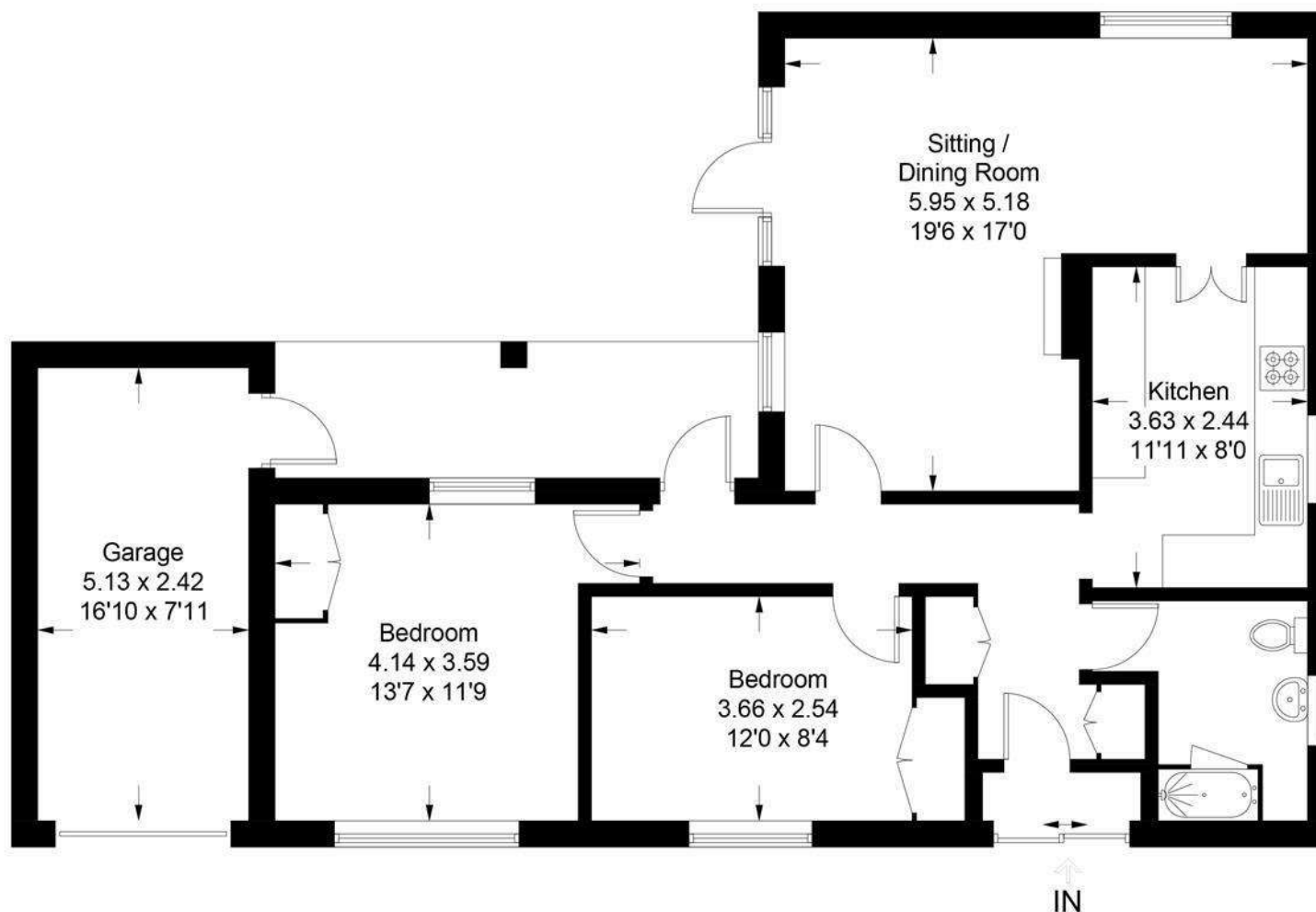

This plan is for layout guidance only. Not drawn to scale unless stated. Windows and door openings are approximate. Whilst every care is taken in the preparation of this plan, please check all dimensions, shapes and compass bearings before making decisions reliant upon them. (ID734752)

www.bagshawandhardy.com © 2021

h.

HOUSE INFORMATION

Approximate total gross internal area:
Bungalow 803 sq ft / 74.6 sq m; Garage 134
sq ft / 12.5 sq m. Total 937 sq ft / 87.1 sq m.

Services: All mains services. Gas-fired central
heating.

Local authority: Runnymede Borough Council.
Tel: 01932 838383.

Viewing: Strictly by appointment. Tel: 01932
283288.

